

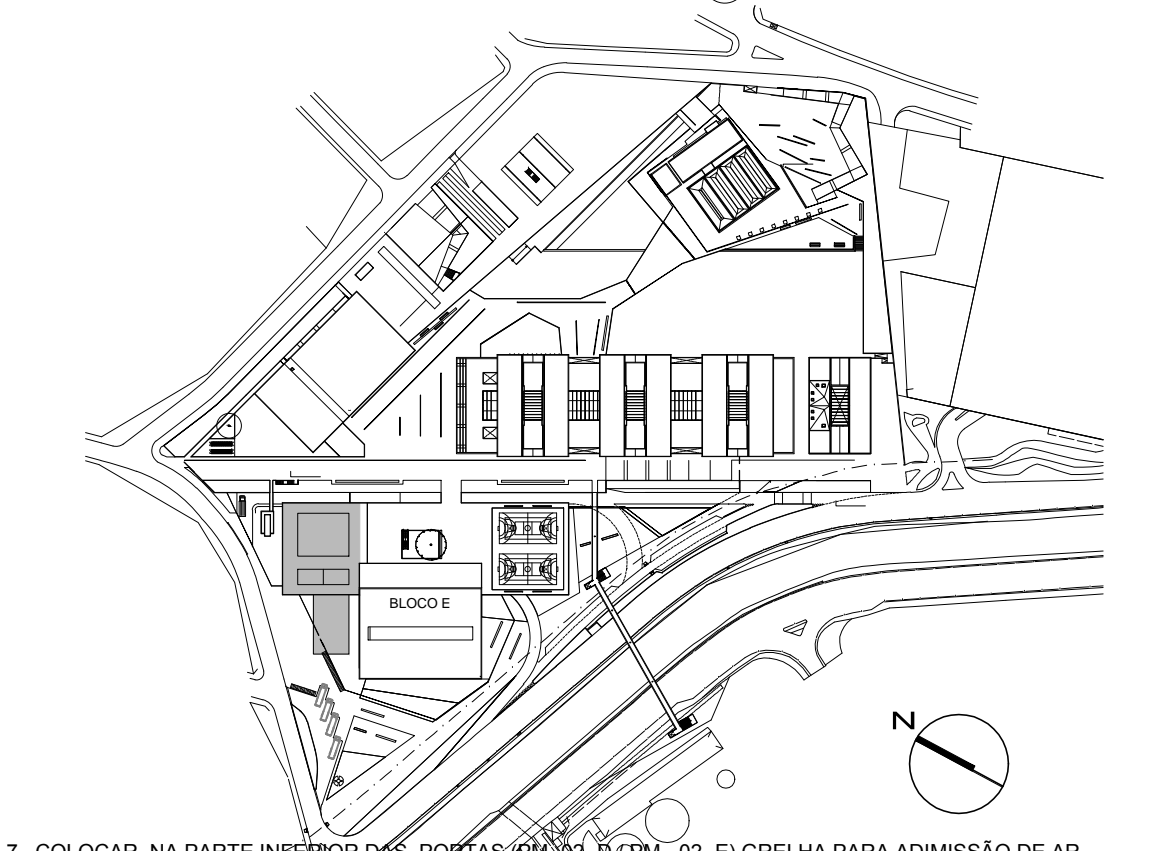
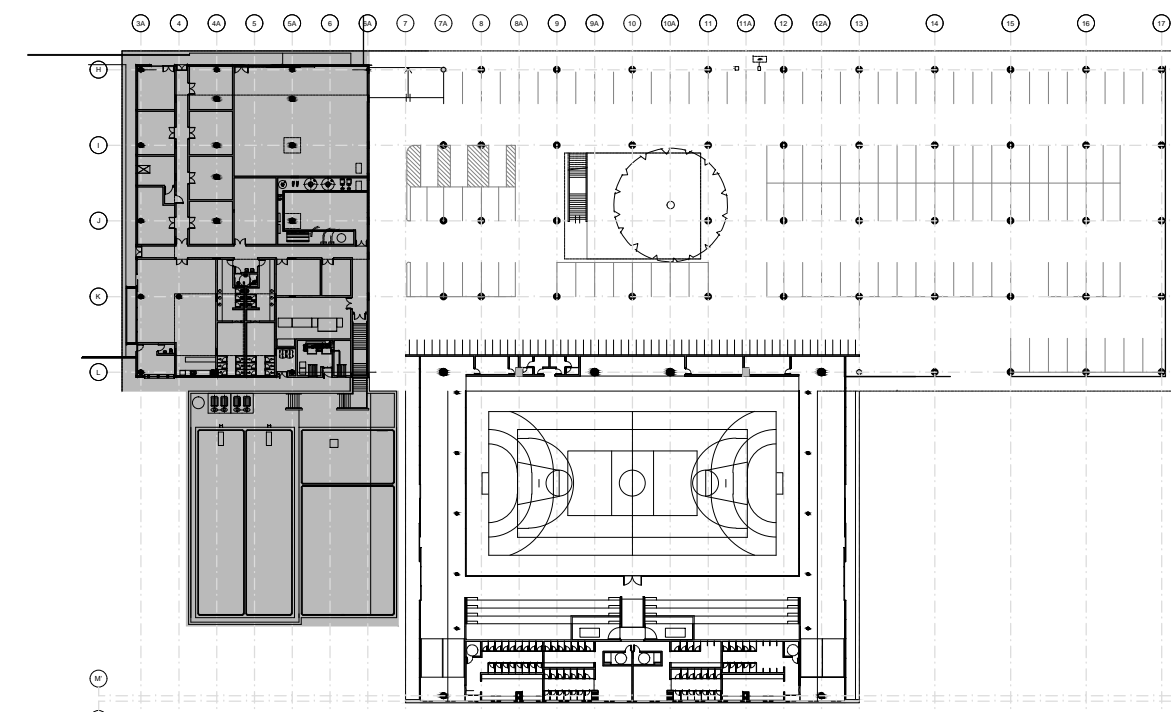

Claudio Libeskind | crea. 040198-7 | al. ribeiro da silva 807 | campos eliseos | 01217-010 | sp | tel 3866 9600 | arc@libeskindlover.it | www.libeskindlover.it

NOTAS

1. AS DIVISÓRIAS DOS BANHEIROS E DOS VESTIÁRIOS SERÃO EM PAINEL, PRÉ-MOLDADO EM ARGAMASSA ARMADA COM REVESTIMENTO EM MASSA GRAXANTE DE LÁTEX, COM BORDA, COM CANAL, COM LATERAL, ABERTA NOS BANHEIROS E FECHADA NOS VESTIÁRIOS COM CANTO DE 45°.
2. PORTAS DE MADEIRA COM REVESTIMENTO EM LAMINADO MELJOMINO.
3. TODOS OS COMPONENTES METÁLICOS EXTERNOS DEVERÃO SER GALVANIZADOS E RECEBER REVESTIMENTO DE FUNDO ANTIOXIDACIONTO ESMALTADO SINTÉTICO ACINTEADO COR P/156.
4. S/O L/NO, ESMALTADO SINTÉTICO ACINTEADO COR S/200, S/201, S/202, S/203, S/204, S/205, S/206, S/207, S/208, S/209, S/210, S/211, S/212, S/213, S/214, S/215, S/216, S/217, S/218, S/219, S/220, S/221, S/222, S/223, S/224, S/225, S/226, S/227, S/228, S/229, S/230, S/231, S/232, S/233, S/234, S/235, S/236, S/237, S/238, S/239, S/240, S/241, S/242, S/243, S/244, S/245, S/246, S/247, S/248, S/249, S/250, S/251, S/252, S/253, S/254, S/255, S/256, S/257, S/258, S/259, S/260, S/261, S/262, S/263, S/264, S/265, S/266, S/267, S/268, S/269, S/270, S/271, S/272, S/273, S/274, S/275, S/276, S/277, S/278, S/279, S/280, S/281, S/282, S/283, S/284, S/285, S/286, S/287, S/288, S/289, S/290, S/291, S/292, S/293, S/294, S/295, S/296, S/297, S/298, S/299, S/300, S/301, S/302, S/303, S/304, S/305, S/306, S/307, S/308, S/309, S/310, S/311, S/312, S/313, S/314, S/315, S/316, S/317, S/318, S/319, S/320, S/321, S/322, S/323, S/324, S/325, S/326, S/327, S/328, S/329, S/330, S/331, S/332, S/333, S/334, S/335, S/336, S/337, S/338, S/339, S/340, S/341, S/342, S/343, S/344, S/345, S/346, S/347, S/348, S/349, S/350, S/351, S/352, S/353, S/354, S/355, S/356, S/357, S/358, S/359, S/360, S/361, S/362, S/363, S/364, S/365, S/366, S/367, S/368, S/369, S/370, S/371, S/372, S/373, S/374, S/375, S/376, S/377, S/378, S/379, S/380, S/381, S/382, S/383, S/384, S/385, S/386, S/387, S/388, S/389, S/390, S/391, S/392, S/393, S/394, S/395, S/396, S/397, S/398, S/399, S/400, S/401, S/402, S/403, S/404, S/405, S/406, S/407, S/408, S/409, S/410, S/411, S/412, S/413, S/414, S/415, S/416, S/417, S/418, S/419, S/420, S/421, S/422, S/423, S/424, S/425, S/426, S/427, S/428, S/429, S/430, S/431, S/432, S/433, S/434, S/435, S/436, S/437, S/438, S/439, S/440, S/441, S/442, S/443, S/444, S/445, S/446, S/447, S/448, S/449, S/450, S/451, S/452, S/453, S/454, S/455, S/456, S/457, S/458, S/459, S/460, S/461, S/462, S/463, S/464, S/465, S/466, S/467, S/468, S/469, S/470, S/471, S/472, S/473, S/474, S/475, S/476, S/477, S/478, S/479, S/480, S/481, S/482, S/483, S/484, S/485, S/486, S/487, S/488, S/489, S/490, S/491, S/492, S/493, S/494, S/495, S/496, S/497, S/498, S/499, S/500, S/501, S/502, S/503, S/504, S/505, S/506, S/507, S/508, S/509, S/510, S/511, S/512, S/513, S/514, S/515, S/516, S/517, S/518, S/519, S/520, S/521, S/522, S/523, S/524, S/525, S/526, S/527, S/528, S/529, S/530, S/531, S/532, S/533, S/534, S/535, S/536, S/537, S/538, S/539, S/540, S/541, S/542, S/543, S/544, S/545, S/546, S/547, S/548, S/549, S/550, S/551, S/552, S/553, S/554, S/555, S/556, S/557, S/558, S/559, S/560, S/561, S/562, S/563, S/564, S/565, S/566, S/567, S/568, S/569, S/570, S/571, S/572, S/573, S/574, S/575, S/576, S/577, S/578, S/579, S/580, S/581, S/582, S/583, S/584, S/585, S/586, S/587, S/588, S/589, S/590, S/591, S/592, S/593, S/594, S/595, S/596, S/597, S/598, S/599, S/600, S/601, S/602, S/603, S/604, S/605, S/606, S/607, S/608, S/609, S/610, S/611, S/612, S/613, S/614, S/615, S/616, S/617, S/618, S/619, S/620, S/621, S/622, S/623, S/624, S/625, S/626, S/627, S/628, S/629, S/630, S/631, S/632, S/633, S/634, S/635, S/636, S/637, S/638, S/639, S/640, S/641, S/642, S/643, S/644, S/645, S/646, S/647, S/648, S/649, S/650, S/651, S/652, S/653, S/654, S/655, S/656, S/657, S/658, S/659, S/660, S/661, S/662, S/663, S/664, S/665, S/666, S/667, S/668, S/669, S/670, S/671, S/672, S/673, S/674, S/675, S/676, S/677, S/678, S/679, S/680, S/681, S/682, S/683, S/684, S/685, S/686, S/687, S/688, S/689, S/690, S/691, S/692, S/693, S/694, S/695, S/696, S/697, S/698, S/699, S/700, S/701, S/702, S/703, S/704, S/705, S/706, S/707, S/708, S/709, S/710, S/711, S/712, S/713, S/714, S/715, S/716, S/717, S/718, S/719, S/720, S/721, S/722, S/723, S/724, S/725, S/726, S/727, S/728, S/729, S/730, S/731, S/732, S/733, S/734, S/735, S/736, S/737, S/738, S/739, S/740, S/741, S/742, S/743, S/744, S/745, S/746, S/747, S/748, S/749, S/750, S/751, S/752, S/753, S/754, S/755, S/756, S/757, S/758, S/759, S/760, S/761, S/762, S/763, S/764, S/765, S/766, S/767, S/768, S/769, S/770, S/771, S/772, S/773, S/774, S/775, S/776, S/777, S/778, S/779, S/780, S/781, S/782, S/783, S/784, S/785, S/786, S/787, S/788, S/789, S/790, S/791, S/792, S/793, S/794, S/795, S/796, S/797, S/798, S/799, S/800, S/801, S/802, S/803, S/804, S/805, S/806, S/807, S/808, S/809, S/810, S/811, S/812, S/813, S/814, S/815, S/816, S/817, S/818, S/819, S/820, S/821, S/822, S/823, S/824, S/825, S/826, S/827, S/828, S/829, S/830, S/831, S/832, S/833, S/834, S/835, S/836, S/837, S/838, S/839, S/840, S/841, S/842, S/843, S/844, S/8

[illegible]

7. COLOCAR NA PARTE INFERIOR DAS PORTAS (PM-02, D/PM-02-E) GRELHA PARA ADMISSÃO DE AR 2,5X16,5 CM MOD AGS-T

UFABC	UNIVERSIDADE FEDERAL DO ABC	
	CONTEÚDO PAGAMENTO INFERIOR – MANUTENÇÃO	ETAPA 1 ABRA TELA 2000 PE/AR
	BLOCO E – ESPORTIVO	N. FOLHA
	ETAPA 1 ABRA TELA 2000	E
	PROJETO EXECUTIVO	01
ESCALA 1:75	DATA 31/08/15	PERÍODO R00